

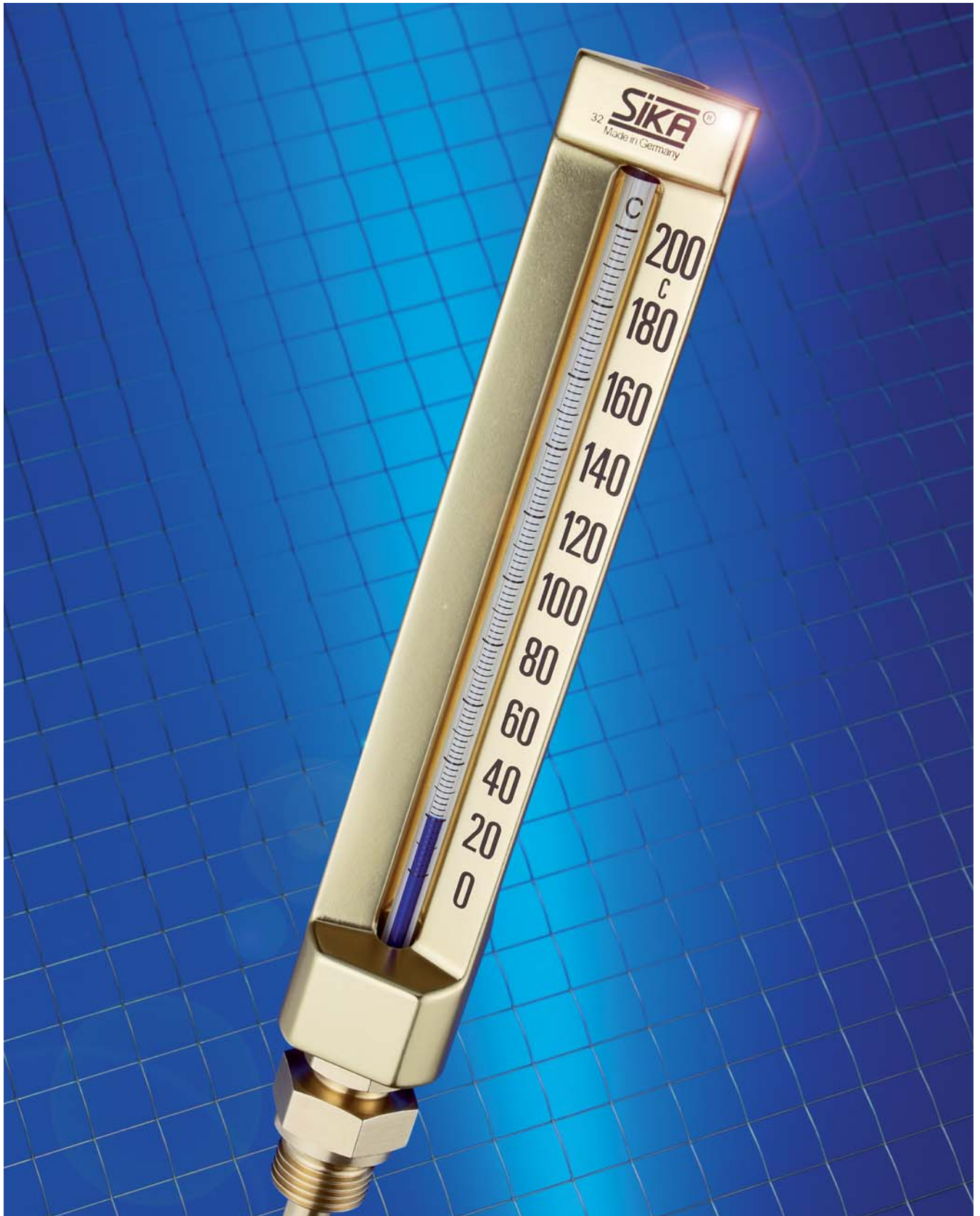

SIKA[®]
founded 1901
Dr. Siebert & Kühn GmbH & Co. KG

Industrial Thermometers



Quality by Tradition

Since 1901 we at SIKA – Dr. Siebert and Kühn have produced precision measuring and control instruments.

The original “SIKA” thermometer was developed and brought to production stage by the engineer Hans Siebert. For its basic mechanical design, Dr. Siebert and Kühn finally received the patent no. 767477 in 1939. From those early days on, we have been manufacturing these thermometers solely in Kassel/Kaufungen – that is real quality “made in Germany”.

Today, many users worldwide speak about a “SIKA” thermometer when considering industrial glass thermometers. SIKA thermometers are cost-effective, accurate and mechanically robust. They are well known for their exceptional long life durability and highest quality

Mechanical parts as well as glass inserts of our standard types are produced in automated manufacturing processes. However, the glass inserts of special versions, e. g. high temperature versions are still produced by our glassblowers in traditional handcraft. Thanks to our long-year experience, we are in the position to produce custom versions on request.

Our Range

On the following pages you will find an overview of our extensive range of industrial thermometers. The range in this catalogue includes more than 17,000 different models.

You can obtain popular types from us off the shelf or within a few days. Less popular or customer-specific models are produced to order. The latter are generally available in quantities of 10 units per model.

This catalogue includes the most important models. In addition, there is a multitude of customer-specific special designs that are used throughout the world. We can provide these special models on request.

Please don't hesitate to contact us with any questions about models and availability.

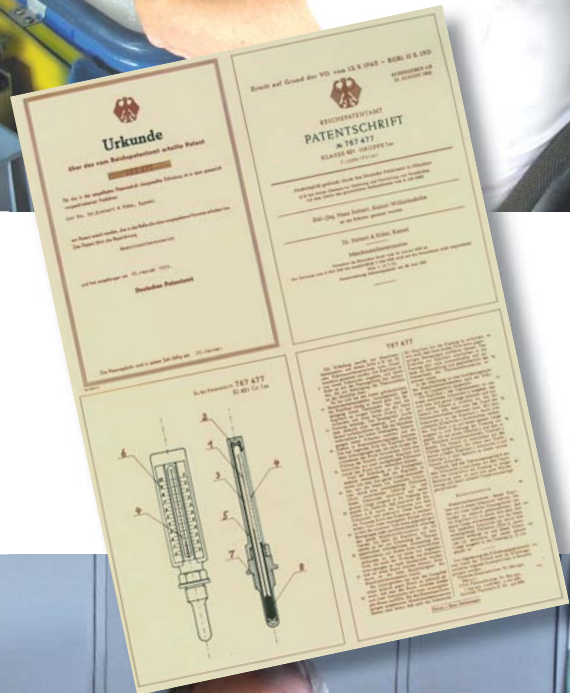

Details of Construction

Casing

Aluminum, V-shaped, completely polished, gold-coloured anodized (or silver-coloured upon request). Numerals of reading scale printed on the right side. Printing black-colored for easy readability. Straight types adjustable to any desired viewing position and locked by brass nut, wrench size 22. Angle thermometers (90 degrees) have a grooved adapter piece with locking screw. Advantage: When mounting the thermometer, it is not necessary to turn the casing.

Glass Inserts (Capillaries)

Capillary tube of solid glass, bar-shaped, prismatic (optic enlargement of the column, except for high temperature types), diameter approx. 6 mm, oval opening, with yellow background for mercury and white background for blue fluid column. Scale is deeply burnt in black, thus being absolutely resistant. The main graduations, which correspond with the printing on the casing, are especially clearly outlined.

Thermometric liquid

In the standard version from -30 to 250 °C blue thermometric liquid ("Fü"); for temperatures above 250 °C only mercury is possible (short designation "Hg"). On request, SIKA thermometers can be supplied with mercury as thermometric fluid from as low as -30 °C.

Immersion tube

Standard version made from brass for temperatures up to 300 °C, from steel for higher max. temperature. On request, high-strength brass or CuNiFe alloy suitable for sea water. Stainless steel for aggressive media. The diameter of the type "B" immersion tube is 10 mm; the wall thickness 1 mm.

Accuracy

The thermometers filled with mercury are accurate to around 1 % of the full scale value; for thermometers with wetting liquid the values are within DIN 16195.

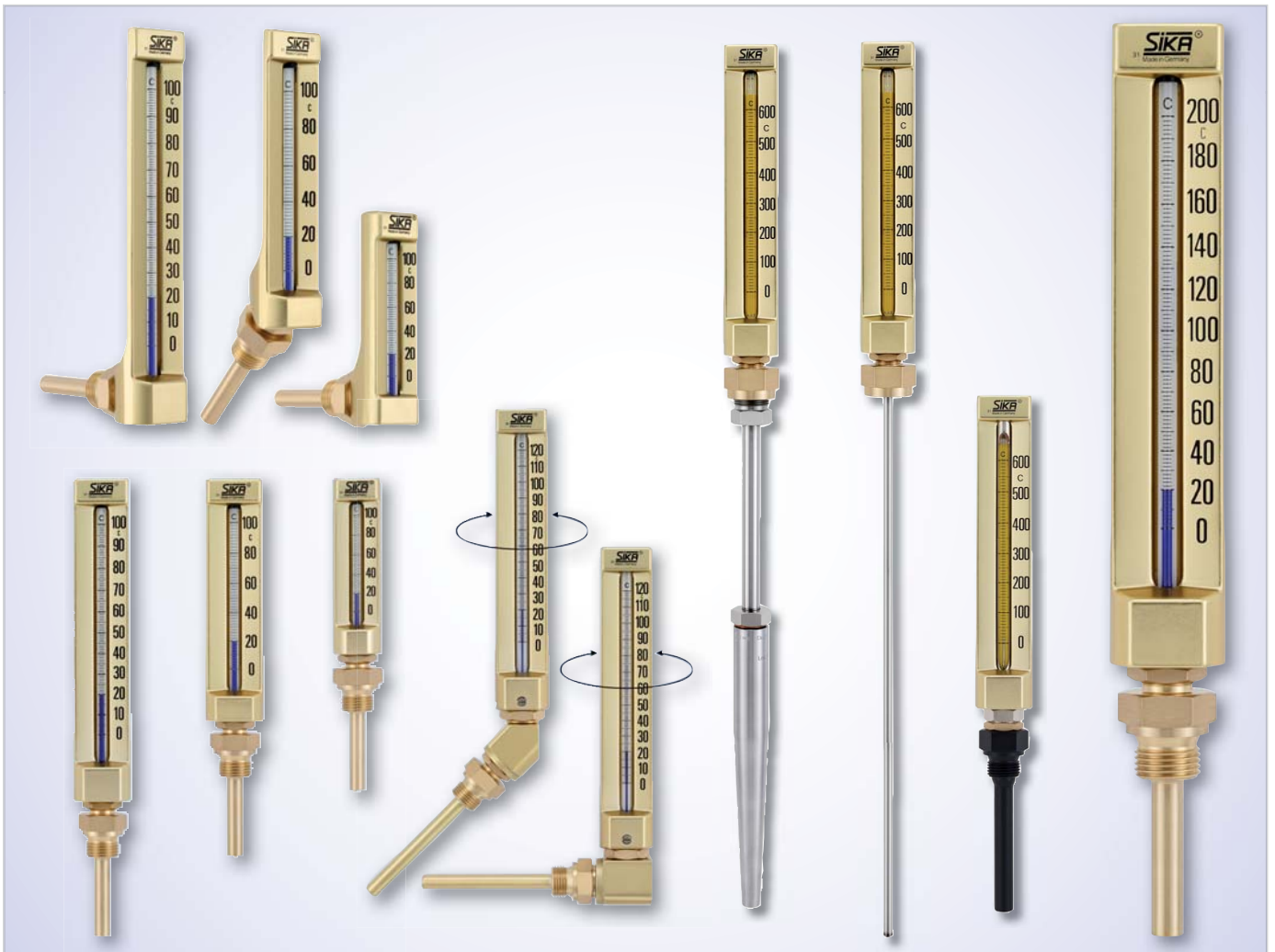

SIKA-Type B with Male Thread

Casing 200 x 36 mm

DIN 16189 B, B1. DIN 16190 S, S1 and DIN 16191 B, B1

Order-Example	271	2	35	1	1	063	2	1
Thermometer type								
straight	271							
angle 90°	272							
angle 135°	273							
Immersion tube type								
B =		2						
Measuring ranges								
-30...50 °C =			35					
0...60 °C =			06					
0...100 °C =			10					
0...120 °C =			12					
0...160 °C =			16					
0...200 °C =			20					
0...250 °C =			25					
0...300 °C =			30					
0...600 °C =			60					
Scale								
Celsius (°C)				1				
Celsius + Fahrenheit (°C + °F)				2				
Filling								
Standard blue fluid for ranges up to 250 °C					Fü = 1			
Mercury for ranges above 250 °C					HG = 2			
Immersion tube length								
l ₁ in mm				63 =	063			
				100 =	100			
				160 =	160			
				250 =	250			
Connection thread								
G1/2 / SW27 =							2	
G3/4 / SW32 =							3	
M20x1.5 / SW27 =							7	
M27x2 / SW32 =							9	
Immersion tube material								
Brass								1
Steel								2
Stainless steel								3
Special brass								4
Copper-nickel alloy								5
If required please ask for our specification sheet „Immersion tube material“								

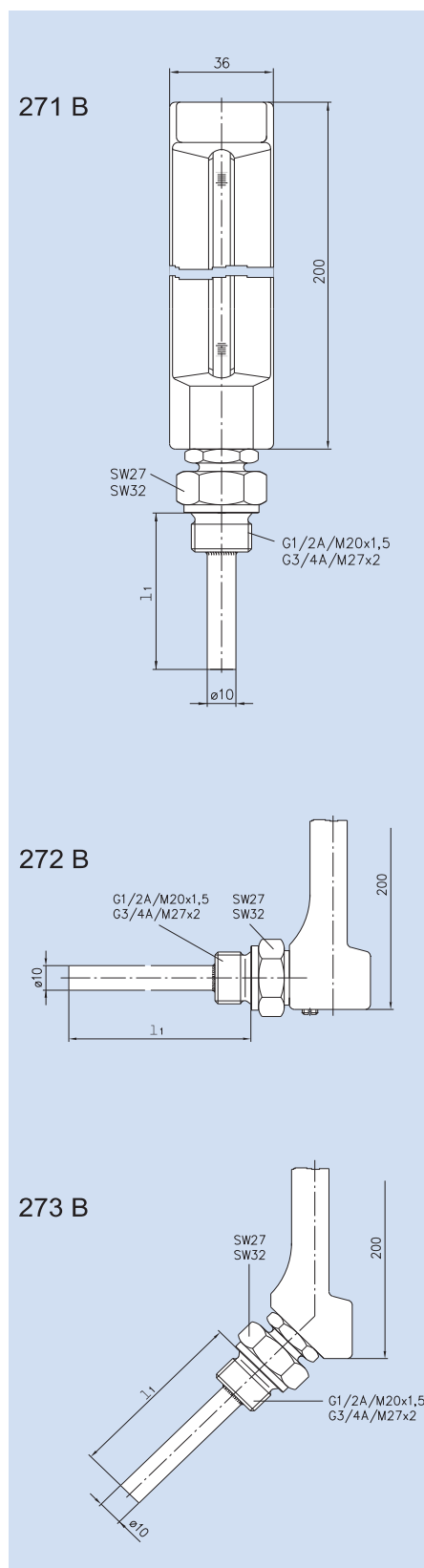

SIKA-Type B with Male Thread

Casing 150 x 36 mm

DIN 16185 B and DIN 16186 S

Order-Example	291	2	35	1	1	063	2	1
Thermometer type								
straight	291							
angle 90°	292							
angle 135°	293							
Immersion tube type								
B =		2						
Measuring ranges								
-30...50 °C =			35					
0...60 °C =			06					
0...100 °C =			10					
0...120 °C =			12					
0...160 °C =			16					
0...200 °C =			20					
0...250 °C =			25					
0...300 °C =			30					
0...600 °C =			60					
Scale								
Celsius (°C)				1				
Celsius + Fahrenheit (°C + °F)				2				
Filling								
Standard blue fluid for ranges up to 250 °C				Fü = 1				
Mercury for ranges above 250 °C				HG = 2				
Immersion tube length								
l ₁ in mm				63 =	063			
				100 =	100			
				160 =	160			
				250 =	250			
Connection thread								
G1/2 / SW27 =							2	
M20x1.5 / SW27 =							7	
Immersion tube material								
Brass								1
Steel								2
Stainless steel								3
Special brass								4
Copper-nickel alloy								5
If required please ask for our specification sheet „Immersion tube material“								

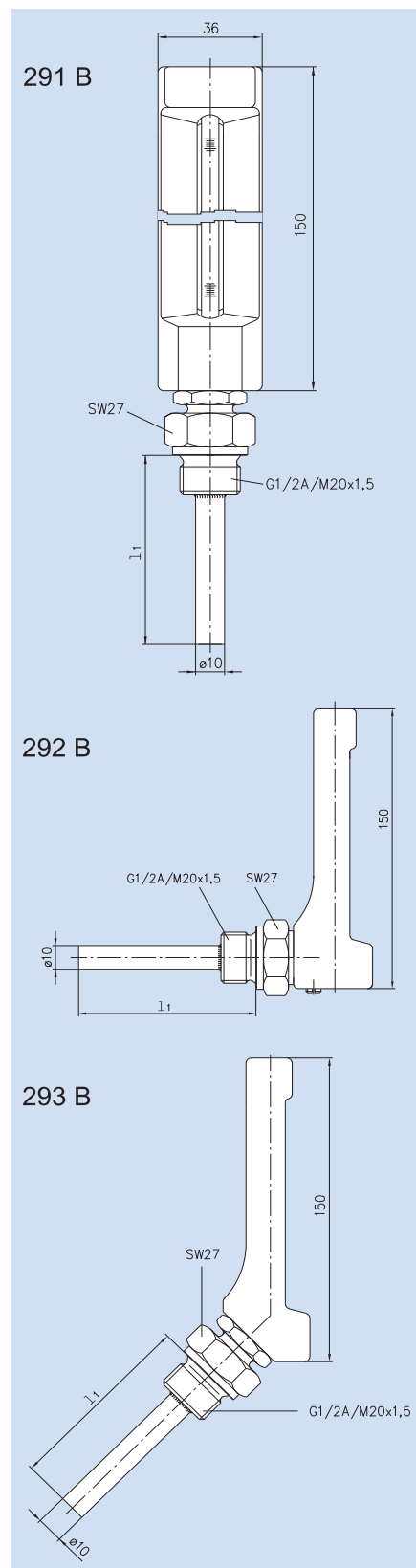

SIKA-Type B with Male Thread

Casing 110 x 30 mm

DIN 16181 B, B1 and DIN 16182 S, S1

Order-Example	174	2	35	1	1	030	2	1
Thermometer type								
straight	174							
angle 90°	175							
angle 135°	176							
Immersion tube type								
B =		2						
Measuring ranges								
-30...50 °C =			35					
0...60 °C =			06					
0...100 °C =			10					
0...120 °C =			12					
0...160 °C =			16					
0...200 °C =			20					
Scale								
Celsius (°C)				1				
Celsius + Fahrenheit (°C + °F)				2				
Filling								
Standard blue fluid for ranges up to 250 °C				Fü = 1				
Immersion tube length								
l ₁ in mm				30 =	030			
				40 =	040			
				63 =	063			
				100 =	100			
				160 =	160			
				250 =	250			
Connection thread								
G3/8 / SW22 =					1			
G1/2 / SW27 =					2			
M16x1.5 / SW22 =					5			
M20x1.5 / SW27 =					7			
Immersion tube material								
Brass					1			
Steel					2			
Stainless steel					3			
Special brass					4			
Copper-nickel alloy					5			
If required please ask for our specification sheet „Immersion tube material“								

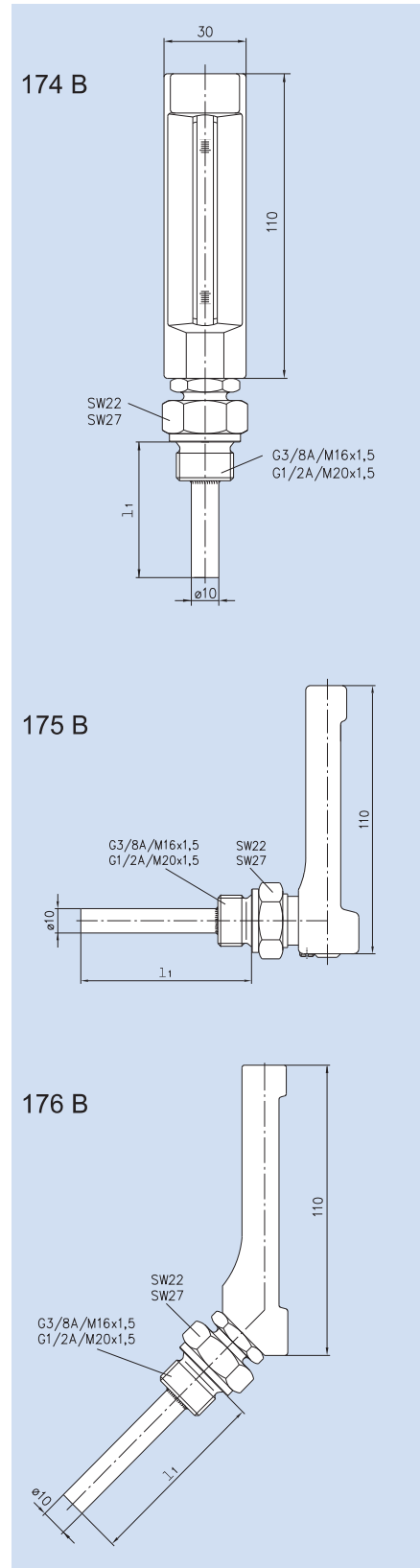

SIKA-Type Da with Union Nut

Casing 200 x 36 mm

DIN 16189 C, C1. DIN 16190 S, S1 and DIN 16191 C, C1

Order-Example	271	3	35	1	1	089	2	A
Thermometer type								
straight	271							
angle 90°	272							
angle 135°	273							
Immersion tube type								
Da =		3						
Measuring ranges								
-30...50 °C =			35					
0...60 °C =			06					
0...100 °C =			10					
0...120 °C =			12					
0...160 °C =			16					
0...200 °C =			20					
0...250 °C =			25					
0...300 °C =			30					
0...600 °C =			60					
Scale								
Celsius (°C)				1				
Celsius + Fahrenheit (°C + °F)				2				
Filling								
Standard blue fluid for ranges up to 250 °C				Fü = 1				
Mercury for ranges above 250 °C				HG = 2				
Immersion tube length								
l ₁ in mm								
with union nut G1/2, M20x1.5 (SW27)								
			89 =			089		
			126 =			126		
			186 =			186		
			276 =			276		
			426 =			426		
with union nut G3/4, M27x2 (SW32)								
			93 =			093		
			130 =			130		
			190 =			190		
			280 =			280		
			430 =			430		
Union nut made of brass								
			G1/2 =			2		
			M20x1.5 =			7		
			G3/4 =			3		
			M27x2 =			9		
Immersion tube material								
Standard:	up to 300 °C = brass							A
	above 300 °C = fitting: brass/tube: steel							C
Option:	fitting and tube: stainless steel							C

1) The lengths of the immersion tubes are in line with protection tubes DIN 16179, DIN 43772, form 8 and 9 and form CS. Please consult our separate catalogue „Protection Tubes for Thermometers“ for further information.

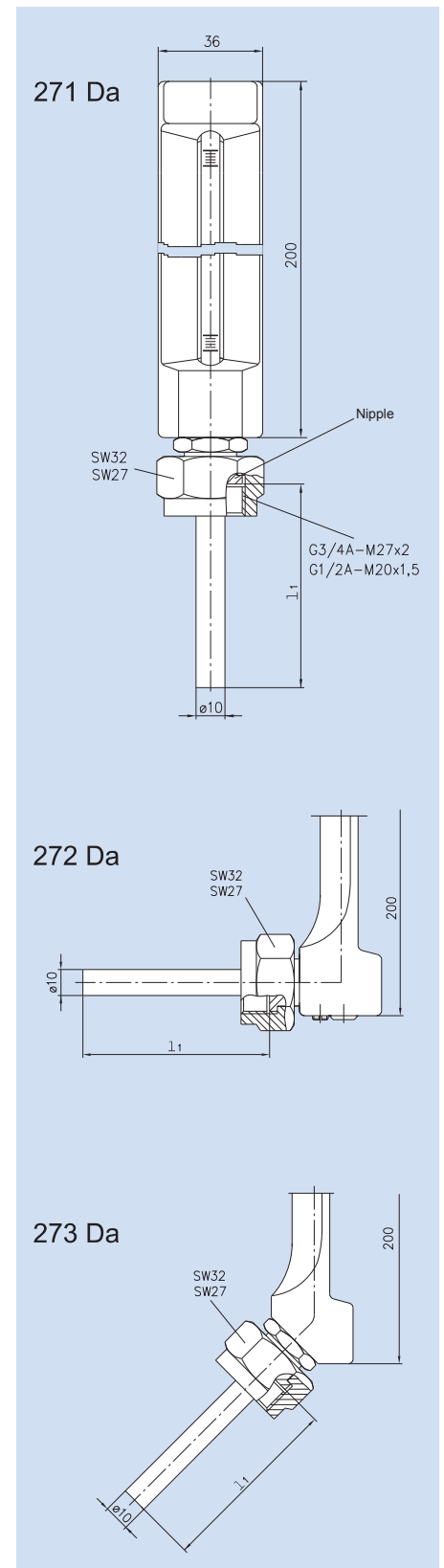

SIKA-Type Dc with Union Nut

Casing 200 x 36 mm

DIN 16189 F

Order-Example	271	5	35	1	1	155	8	A
Thermometer type								
straight	271							
angle 90°	272							
angle 135°	273							
Immersion tube type								
Dc =		5						
Measuring ranges								
-30...50 °C =			35					
0...60 °C =			06					
0...100 °C =			10					
0...120 °C =			12					
0...160 °C =			16					
0...200 °C =			20					
0...250 °C =			25					
0...300 °C =			30					
0...600 °C =			60					
Scale								
Celsius (°C)				1				
Celsius + Fahrenheit (°C + °F)				2				
Filling								
Standard blue fluid for ranges up to 250 °C					Fü = 1			
Mercury for ranges above 250 °C					HG = 2			
Immersion tube length								
l ₃ in mm								
Immersion tube length match				155 =		155		
protection tubes according to DIN 43772, form 4 ¹⁾				215 =		215		
				275 =		275		
				295 =		295		
				355 =		355		
				415 =		415		
Union nut made of brass								
				M24x1.5 =			8	
Immersion tube material								
Fitting: brass / Tube: stainless steel								A

¹⁾ We supply thermometers in the Dc range with a Ø 6.5 mm steel tube over the bottom of the capillary tube, suitable for protection tubes with a bore of 7 mm. Please consult our separate catalogue „Protection Tubes for Thermometers“ for further information.

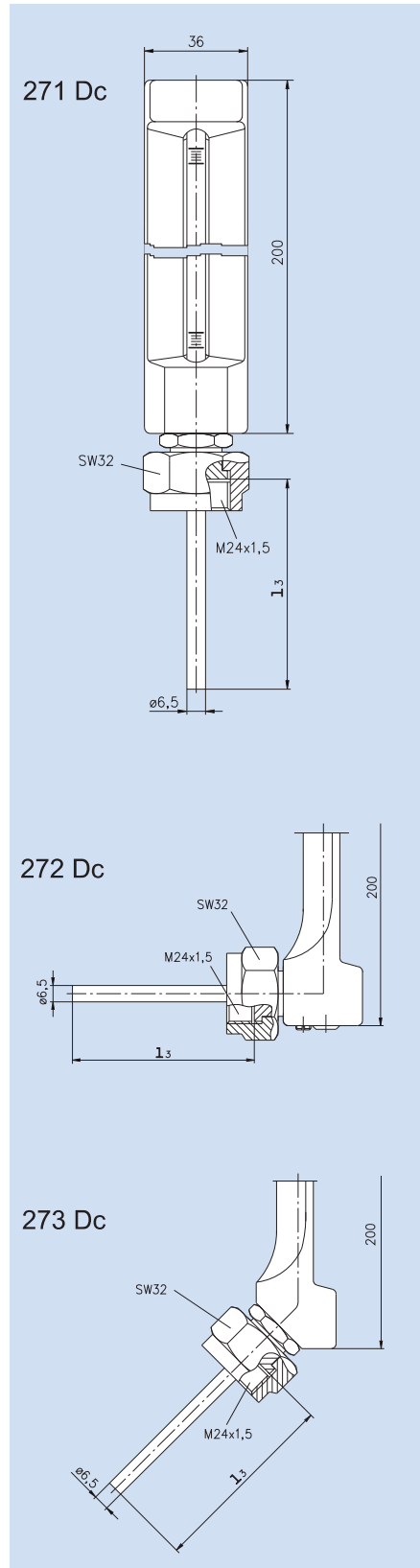

SIKA-Thermometers

Special models & options



Bdr Type Rotatable Angle Model

The casing of the original Bdr type SIKATHERMOMETER can be rotated axially through 360° and therefore be adjusted to be read from any angle. Available as Type 272, 292 and 175

BF Type Vibration-resistant Model

Thermometer for use in applications exposed to strong vibrations, e.g. on large diesel engines. The glass insert is glued into a steel nickel plated tube and this is spring-mounted in the casing. Highest possible resistance to column separation. Available as Type 271 BF and 291 BF, scale ranges 0...100 °C and 0...600 °C.

Tank-Thermometer Type 277

Thermometer for measuring temperatures in fluid tanks. With a perforated cup-shaped base. Measuring range 0...120 °C.

Type 278 Room Thermometer

For measuring the ambient air temperature indoor and outdoor. Casing 200 x 36 mm with mounting bracket fitted to the top. Measuring ranges -30...50 °C and 0...100 °C available.

Options for all models (on request, at extra cost)

- Other measuring ranges
- Other immersion tube lengths and materials
- Other connection threads
- Silver-coloured casing
- Thermometer completely free of non-ferrous metal
- Limit thermometer with 1 pair of limit indicators - adjustable to any interval
- Thermometer with sealing sleeve - reduces the penetration of moisture into the immersion tube (outdoor mounting, low temperature applications)

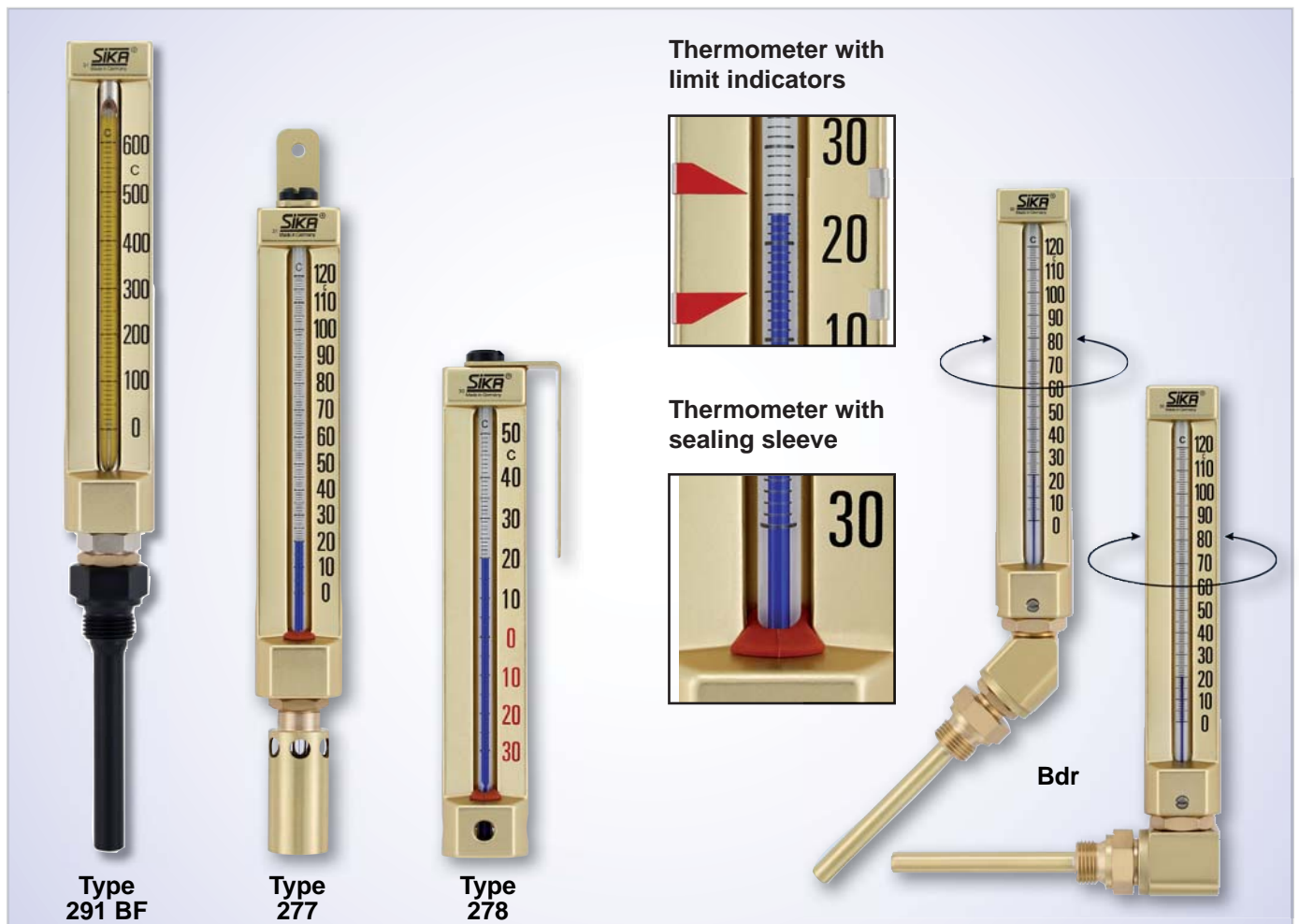

Spare Parts

For original SIKA thermometers

Thermometer Inserts

Order-Example	271	5	35	1	1	155
Thermometer type						
straight	174					
	291					
	271					
angle 90°	175					
	292					
	272					
angle 135°	176					
	293					
	273					
Immersion tube type						
for thermometers						
with fixed connection thread	B	2				
with union nut	Da	3				
	Dc	5				
Measuring ranges						
-30...50 °C =			35			
0...60 °C =			06			
0...100 °C =			10			
0...120 °C =			12			
0...160 °C =			16			
0...200 °C =			20			
0...300 °C =			30			
0...600 °C =			60			
Scale						
Celsius (°C)				1		
Celsius + Fahrenheit (°C + °F)				2		
Filling						
Standard blue fluid for ranges up to 250 °C				Fü = 1		
Mercury for ranges above 250 °C				HG = 2		
Immersion tube length						
Immersion length l_1 and l_3 respectively in mm						30
(according to complete thermometers)						40
for types B with fixed connection thread						63
						100
						160
						250
for types Da						89
with union nut G1/2 or G3/4						93
						126
						130
						186
						190
						276
						280
						426
						430
for types Dc						155
with union nut M24x1.5						215
						275
						295
						355
						415

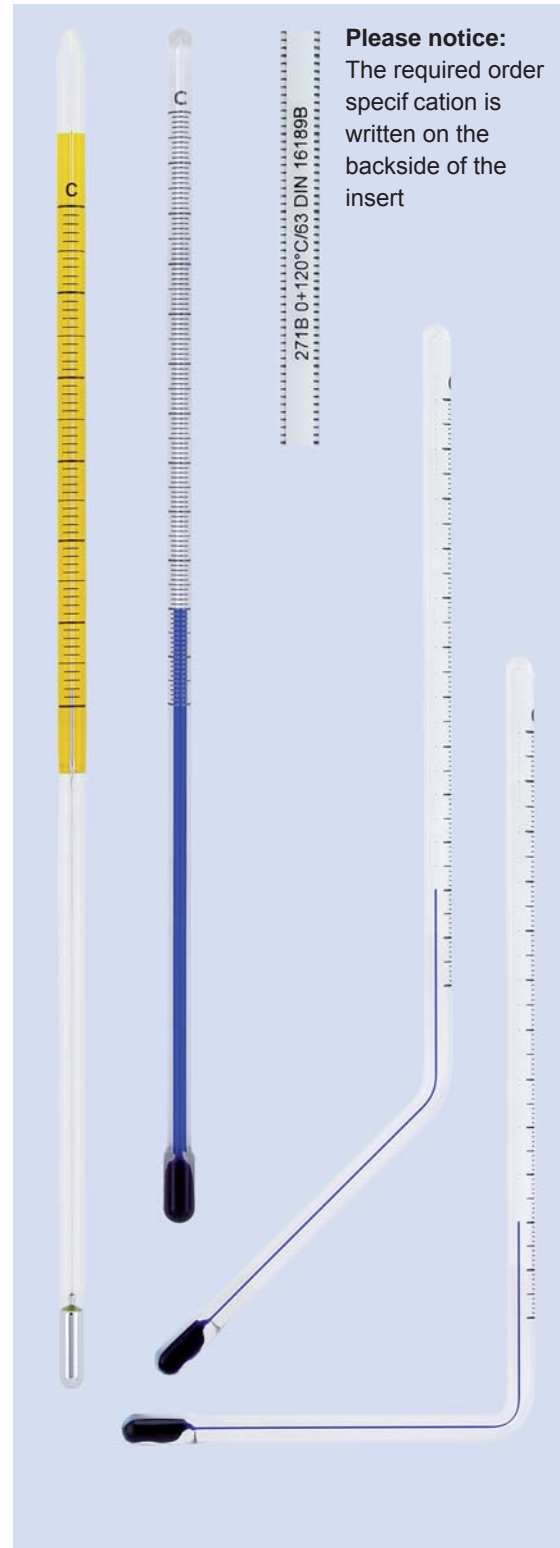

Please notice:
The required order specification is written on the backside of the insert

Spare glass inserts include required small mounting parts.

Spare Parts

For original SIKA thermometers

Casings and Immersion Tubes

Thermometer casings

Order-Example	271	0	35	1
Thermometer type				
straight	200 x 36 mm	271	0	
angle 90°	200 x 36 mm	272	0	
angle 135°	200 x 36 mm	273	0	
straight	150 x 36 mm	291	0	
angle 90°	150 x 36 mm	292	0	
angle 135°	150 x 36 mm	293	0	
straight	110 x 30 mm	174	0	
angle 90°	110 x 30 mm	175	0	
angle 135°	110 x 30 mm	176	0	
Measuring ranges				
-30...50 °C =			35	
0...60 °C =			06	
0...100 °C =			10	
0...120 °C =			12	
0...160 °C =			16	
0...200 °C =			20	
0...300 °C =			30	
0...600 °C =			60	
Scale				
Celsius (°C)				1
Celsius + Fahrenheit (°C + °F)				2

Immersion tubes with fixed connection thread, type B

Order-Example	030	5	1	1
Immersion tube length l_1 in mm				
30 =	030			
40 =	040			
63 =	063			
100 =	100			
160 =	160			
250 =	250			
Connection thread				
G3/8A =		1		
G1/2A =		2		
G3/4 A =		3		
G1A =		4		
M16x1.5 =		5		
M20x1.5 =		7		
M27x2 =		9		
Immersion tube material				
Brass =			1	
Steel =			2	
Stainless steel =			3	
Special brass =			4	
Copper-nickel alloy =			5	
Thermometer type				
Straight or angle type 135°				1
Angle type 90°				2



Immersion tube B
for straight or angle type
thermometers 135°

Immersion tube B
for angle type
thermometers 90°

Our Production and Sales Range



Flow Sensors without moving Parts



Turbine Flow Sensors



Flow Switches



Pressure Gauges and Pressure Sensors



Industrial Thermometers



Electronic Digital Thermometers, Dial Thermometers



Measuring Instruments



Temperature Sensors



Calibrators, DKD-Laboratory

Your competent partner for measurement and control

SIKA[®]
founded 1901
Dr. Siebert & Kühn GmbH & Co. KG

...measurement...control...calibration

Phone: 0700 CALL SIKA

Phone: +49 5605 803-0

Fax: +49 5605 803-54

E-Mail: info@sika.net

Internet: <http://www.sika.net>

Struthweg 7-9, 34260 Kaufungen

P. O. Box 11 13, 34254 Kaufungen

Germany

Subject to technical modification

